

**Monday 30<sup>th</sup> June 2025**

## Dear Families

We are pleased to share that students and staff are now making full use of our brand-new **STEAM** block, a fantastic addition to our school that's already significantly enhancing learning across science, technology subjects and maths. These modern facilities are helping to create more engaging lessons and are contributing to improved pupil progress. We are delighted to see our students taking full advantage of the world class learning facilities we now have.

As we approach the end of the academic year, there's a real buzz of excitement amongst students who are looking forward to our rewards trips, celebrating their hard work and achievements. We are also thrilled to be hosting the Year 11 Prom on Tuesday, 1st July, at the beautiful Hawkstone Park, a well-deserved celebration for our leavers.

*Jim Taylor*

**Headteacher**



**Diary Dates:** Rewards Trips week commencing 21<sup>st</sup> July

Last day of this term: Thursday 24<sup>th</sup> July. (Rewards Trips Day)



### **STEM Science:**

This week, our after-school STEM Club at Shrewsbury Academy had a special visit from Claire Ashford of BBC Radio Shropshire. The students were thrilled to showcase their latest experiments and discoveries.

During the session, they explored the science behind levitating flames and investigated the principles of the Davy (miners') lamp. The excitement didn't stop there, they even created clouds in the classroom! Although they didn't find any silver linings, the experience was golden.

Students also had the unique opportunity to be spoken to by the BBC reporter, and they handled it like pros. It was heartwarming to hear how much they enjoy the wide range of after-school clubs we offer. Claire was amazed to see our young Scientists working after school to enrich their learning. Regular bulletin readers will know this is normal for our students under the watchful eye of Miss Allsop.

Next week promises even more fun as we bounce eggs and rock the chocolate cycle!



## STEM: Technology

As part of their Digital Design unit, Year 9 students at Shrewsbury Academy embarked on an exciting project to create unique cupcake box logos for a fictional brand. This hands-on experience introduced them to key design principles such as digital illustration, typography, colour theory, and branding.

Students used a range of tools including Microsoft Paint, Adobe Photoshop Elements, and most notably Wacom drawing tablets, which are widely recognised as the industry standard for professional graphic designers. These tablets allowed students to experiment with precision and creativity, simulating real-world design workflows.

Whether working with a stylus on a tablet or using a standard mouse, students demonstrated impressive creativity and technical skill. Their final logos ranged from playful and pastel to sleek and minimalist, reflecting a strong understanding of brand identity.

Shrewsbury Academy  
Part of the Marches Academy Trust

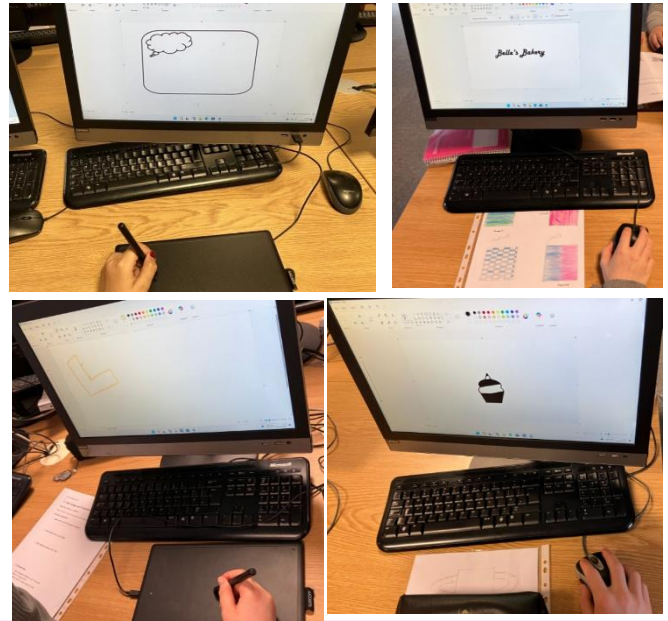

## Equine Assisted Learning

Students at Shrewsbury Academy were thrilled to participate in Equine Assisted Learning sessions this term, an innovative program that uses interactions with horses to support personal development. These sessions offer a wide range of benefits, particularly in building students' self-confidence and enhancing their communication and assertiveness skills. Working closely with horses requires calm, clear, and consistent communication, which helps students become more aware of their body language and tone.

Additionally, the sessions can be structured around teamwork, encouraging students to collaborate and support one another. This not only strengthens peer relationships but also fosters a sense of trust and mutual respect. The unique environment of working with animals outside the traditional classroom setting provides a refreshing and engaging learning experience.



Shrewsbury Academy  
Part of the Marches Academy Trust

Shrewsbury Academy  
Part of the Marches Academy Trust



Summer Term Programme  
Part 2 June/July

**Tuesday 3 June** – Science (geology to be specific) rocks! Model and marvel at the formation of intrusive and extrusive igneous rocks. Great for anyone who loves a microscope and sparkly crystals! **Loved this** – geologists can strike it lucky in many fields from extracting oil or mining diamonds to studying the surface of the moon!

**Tuesday 10 June** – No STEAM Club today due to whole staff training.

**Tuesday 17 June** – Give us a wave! Made from jelly babies! Teamwork will make the dream work as we pull together to make a giant wave machine – yes you guessed it – made from jelly babies. Then your fabulous Science Teachers will make a baby scream! Aghhhhhhhhhhh! **Wonderful waves and the world of physics offers a multitude of careers: from audiology to radiology, there are hundreds of jobs that require knowledge of waves. Isn't physics fabulous!**

**Tuesday 24 June** – Burning Bunsens! Learn the levitating flame trick inspired by the principles of a miner's safety lamp. Then make a cloud in a can. **Love fire? Why not join the fire brigade or train as a pyrotechnic!**



Shrewsbury Academy

## Lunchtime Board Games Clubs

**Who:** All years

**When & where:**

Mondays: GC3 & H12

Tuesdays: GC3 & H13

Wednesdays: GC3 & H13

Thursdays: GC3 & H13

Fridays: GC3 & H12

**What:** A variety of board games are available, just come with your lunch!



Shrewsbury Academy  
Part of the Marches Academy Trust





## PE SUMMER INTERHOUSE

### Summer Interhouse Competitions – Final Week of Term!

Get ready for some fun and friendly competition! Our **Summer Interhouse** events will take place during the **last week of term**. All year groups are welcome, and teams will be **mixed gender**.

#### Events Schedule:

- **Rounders** – Monday, 21st July Afterschool
- **Cricket** – Tuesday, 22nd July Afterschool

Bring your house spirit and join in! Pop down to PE to sign up.



## Before and After School PE Clubs

SHREWSBURY ACADEMY SPORTS NEWS

### Physical Education Clubs Programme – Summer 2025

Day	Before School	After School
<b>Monday</b>		All Years – Athletics - Mr Dobson, Mr Dean, Miss Weaver, Miss Verrilli (Front Field)
<b>Tuesday</b>	All Years - Fitness – Miss Weaver (Fitness Suite)	All Years – Cricket (Boys and Girls) Mr Lawrenson, Mr Dean (Front Yard) All Years – Fitness – Miss Verrilli (Fitness Suite)
<b>Wednesday</b>	All Years - Fitness - Mr Dobson (Fitness Suite)	All Years –Rounders- Miss Weaver, Miss Verrilli (Back Field) (This will be split in Year Groups) All Years – Fitness - Mr Dobson (Fitness Suite)
<b>Thursday</b>	All Years - Fitness - Mr Dean (Fitness Suite)	School Meetings (No Clubs)
<b>Friday</b>	All Years - Fitness – Miss Verrilli (Fitness Suite)	All Years - Fitness – Mr Lawrenson (Fitness Suite)
<p><b>Details:</b>                      All Before school clubs will run from 7.30am – 8.30am unless stated                      All After school clubs will run from 3.10pm until 4.10pm                      Please speak to a member of staff who is running the club if further details required.                      Full PE kit is always expected to be worn for all extra-curricular activities.</p>		



## Our New LRC

We are excited to share that our Library/Learning Resource Centre is becoming a vibrant hub for learning once again. This beautiful space is now being used regularly for reading interventions and small group work, helping to support students in a targeted calm and focused environment.

However, whilst the space itself is inspiring, our book collection is currently limited. Although we have begun investing in new titles, many of our reference books are outdated, and we are keen to provide students with a wider, more relevant range of reading materials.

We are reaching out to ask for your support. By following the link below and contributing through book tokens, you can help us restock our library with high-quality, engaging books that will benefit all students.

Your support could make a real difference.



SCAN ME

## SEND at Shrewsbury Academy

If you have any concerns regarding a student's learning needs or would like to request additional support or advice, our **Student Support Team** is here to help.

For any SEN related queries, please do not hesitate to get in touch with the SEN Team: [SENDAdmin@shr.mmat.co.uk](mailto:SENDAdmin@shr.mmat.co.uk)

Our **Special Educational Needs Coordinator (SENCO)**, **Laura Richmond**, works closely with the SEND team to ensure that every student receives the appropriate support. Laura is available to provide guidance, coordinate interventions, and respond to any SEND-related enquiries.

The **Student Support Department** is currently based in the **Bridge area of the Caradoc Building**, before moving to a refurbished purpose designed area of the school in September offering a central and accessible space for students.

We are also proud to have opened **The Lighthouse**—a purpose-built internal assessment and alternative provision area designed to meet a wide range of student needs in a calm and supportive environment.



## SA in Our Community

**ROYAL AIR FORCE**  
REGULAR AIR & RESERVE

**NO ORDINARY JOB**

**FIND YOUR APPRENTICESHIP**

The RAF is honoured and delighted to share the news that the Department of Education has officially recognised and ranked the RAF as number 4 in the top 100 Apprenticeship Employers 2024.

We offer Apprenticeships in the following roles:

- ENGINEERING**  
Aircraft Technician (Avionics)  
Aircraft Technician (Mechanical)  
Weapons Technician  
Electrician
- CYBERSPACE**  
Communications Infrastructure Technician  
Cyberspace Communication Specialist
- LOGISTICS**  
Driver  
Motor Vehicle Technician  
Chef  
Air & Ground Steward
- AIR & SPACE OPERATIONS**  
Air Traffic and Weapons Controller  
Naval Officer
- SECURITY & RESILIENCE**  
RAF Police  
RAF Regiment Gunner
- MEDICAL SERVICES**  
RAF Medical
- INTELLIGENCE**  
Intelligence Analyst
- PEOPLE OPERATIONS**  
Physical Training Instructor

To find out more about how we can help your students into an apprenticeship please contact our team on:  
Email: [CRN-CareersEngageMids@mod.gov.uk](mailto:CRN-CareersEngageMids@mod.gov.uk)

Download our App to find out more about a career in the Royal Air Force

Apprenticeships 4



Some of our students have **severe allergies**. Please respect our drive to be a 'nut free school.' Always leave snacks and foods containing nuts at home.



## Become a Junior Ambassador



### Are you?

- ✓ Aged between 13-17
- ✓ Confident and Outgoing
- ✓ Interested in meeting people from around the world

### Why Join?

- FREE Trips to Liverpool, Manchester, Alton Towers and many more....
- Join our discos and sports days at Shrewsbury School.
- Gain new skills and great life experiences.



### JOIN NOW

[equity@severnvalle.co.uk](mailto:equity@severnvalle.co.uk) 01743 232505  
[www.severnvalle.co.uk](http://www.severnvalle.co.uk)

To Become an Ambassador please register through our website, email or by clicking **JOIN NOW**

Please note that all excursions and on-site activities are subject to availability and that on some excursions places may be limited.

Most pharmacies can help you with **seven common conditions** without needing a GP appointment

- Sinusitis (adults and children aged 12 years and over)
- Sore throat (adults and children aged 5 years and over)
- Earache (children and young adults aged 1 year to 17 years)
- Infected insect bite (adults and children aged 1 year and over)
- Impetigo (adults and children aged 1 year and over)
- Shingles (adults aged 16 years and over)
- Urinary tract infection (women, aged 16 to 64 years)

Ask your pharmacy for more information about this free\* NHS service

**Visit your Pharmacy First!**

\*NHS prescription charge rules apply where a medicine is supplied



Click [here](#) to view our latest news articles.

Why not also follow us on Facebook @[ShrewsburyAcademy](#) for a wealth of content, from student, staff and school celebrations to competitions. We encourage you to get interactive with our posts!

To hear about news from across the Trust, why not also follow @[MarchesAcademyTrust](#).

**Want to work for the Marches Multi Academy trust? Follow the link below:**

<https://www.marchesacademytrust.co.uk/joining-us/how-to-join>



**Shrewsbury Academy, Corndon Crescent, Shrewsbury, SY1 4LL**  
**01743 276700**  
**info@shr.mmat.co.uk**  
**shrewsburyacademy.co.uk**

