

Monday 21st July 2025

Dear Families,

What a year it's been at Shrewsbury Academy! This is our final bulletin of the 2024-2025 academic year.

As we wrap up the summer term, I want to take a moment to reflect on the incredible journey we have been on as a community.

The opening of our new multi-million-pound STEM building - This state-of-the-art facility is transforming the way our students learn and engage with science, technology, engineering, and maths and has been huge this year. With nine brand-new science rooms, modern maths classrooms, and cutting-edge design and technology spaces, our students are already benefitting from an environment that inspires innovation and curiosity. We have also unveiled our stunning new library, a world-class space designed to foster a love of reading, research, and independent learning. We are so excited to now be able to develop this space as a central part of our school.

Another highlight has been the opening of The Shore – a dedicated facility for our Year 7 students. This bespoke space includes its own learning areas, restaurant, and toilets, giving our younger students a sense of independence and belonging as they transition into secondary school life. The build is set to conclude over the summer holidays, and we can't wait to welcome everyone back in September to a fully completed campus that reflects our commitment to excellence and opportunity for all.

I want to thank our students for their energy, their kindness, and their determination. You have made this year truly special. To our staff, parents, and wider community – your support has been invaluable, and together we have created something extraordinary.

Have a restful and joyful summer break. We look forward to seeing you all in the new academic year, ready to embrace new challenges and celebrate even more successes.

Jim Taylor

Headteacher



Diary Dates: Last day of this term: Thursday 24th July. (Rewards Trips Day)

First day of next term: **Year 7 only** Tuesday 2nd September, **Years 8-11** Wednesday 3rd September



Year 10 Work Experience

What a fantastic week it's been for our Year 10 students!

Those out on work experience placements have truly impressed. We've had glowing feedback from employers, who praised their professionalism, enthusiasm, and maturity. It's been inspiring to see our students thrive in real-world environments—gaining confidence, building skills, and getting a real taste of the working world. It's opened doors, sparked ambition, and shown just how bright their futures can be. We couldn't be prouder!

Meanwhile, students who stayed in school had an equally exciting week. They took part in a wide range of activities designed to broaden their horizons and raise aspirations. Highlights included hands-on sessions with Tilbury Douglas (the team behind our new STEAM block and Shore facility), workplace insights from PC Thomas Rayment, and inspiring talks from Smash Life and Staffordshire University.

They also explored financial maths, careers in science, food and humanities, and even crafted some powerful speeches, developing critical thinking and communication skills along the way.

A huge well done to all our students for making the most of every opportunity, and a big thank you to our staff and partners for making it all possible. The energy, ambition, and positivity this week has brought is something we'll carry forward into the new school year.



Orchestral Day in Full Harmony at Shrewsbury School

This week saw the Barnes Theatre at Shrewsbury School hosting the very first *Orchestral Day*, bringing together around sixty enthusiastic pupils from across several Trust schools, including Shrewsbury Academy, The Marches, The Grove, Idsall, and the Grange. Students played a diverse selection of tunes, from *Viva la Vida* and *James Bond* themes to feel-good classics like *Don't Stop Believin'* and *Mamma Mia*. For many, it was their first time performing in a large ensemble, making it a memorable and confidence-boosting experience.

The day was particularly significant for those beginning their GCSE Music journey this September. Their dedication, enthusiasm, and full engagement throughout the event was a credit to Shrewsbury Academy.

A huge well done to all who took part. Here's to many more musical milestones ahead!



Shrewsbury Academy 
Part of the Marches Academy Trust

Transition – Mount Pleasant Primary School

Mrs Everest and Miss Higgins had a fantastic time visiting the Year 6 pupils at Mount Pleasant Primary School this week, where they delivered a fun and creative Textiles lesson. The children designed their very own bookmarks using cross-stitch techniques, learning how to thread a needle, tie knots, and follow a pattern of their choice. It was brilliant to see them so engaged, focused, and proud of what they created.

These sessions are a key part of our transition programme, helping to make the move to secondary school feel more exciting and familiar. We know that starting Year 7 can be a big step, and activities like this help to ease nerves, build confidence, and give students a taste of what's to come. Meeting staff, trying out new subjects, and getting hands-on with our staff all help to reduce anxiety and make the experience feel less daunting.

We were so impressed with the creativity and enthusiasm shown by every pupil. We can't wait to welcome them properly in September and see them continue their journey in textiles, technology and beyond!



Shrewsbury Academy 
Part of the Marches Academy Trust

Shrewsbury Academy SEND Coffee Morning

We were delighted to welcome families to our very first SEND Coffee Morning, a new initiative designed to strengthen communication and support for our SEND community. The event offered a relaxed space to share strategies, discuss student pathways, and highlight the improvements we've made to our SEND provision. Parents heard about the opening of *The Lighthouse*, our dedicated AP space, and the upcoming purpose-built Bridge area, which is set to launch in September 2025. These developments are part of our commitment to creating inclusive, supportive environments where every student can thrive. Thank you to all who attended and contributed!



Shrewsbury Academy 
Part of the Marches Academy Trust

Shrewsbury Academy Alumni

We are searching for ex-students of Shrewsbury Academy, Sundorne or Grange Schools who would be willing to share with us stories of their lives at school and their career since leaving us. If you would be interested in sharing your story with us, please contact angela.warrilliergrant@shr.mmat.co.uk We want to inspire our students to realise anything is possible for them. #Relentless**SA**mbition



Before and After School PE Clubs

SHREWSBURY ACADEMY SPORTS NEWS

Physical Education Clubs Programme – Summer 2025

Day	Before School	After School
Monday		All Years – Athletics - Mr Dobson, Mr Dean, Miss Weaver, Miss Verrilli (Front Field)
Tuesday	All Years - Fitness – Miss Weaver (Fitness Suite)	All Years – Cricket (Boys and Girls) Mr Lawrenson, Mr Dean (Front Yard) All Years – Fitness – Miss Verrilli (Fitness Suite)
Wednesday	All Years - Fitness - Mr Dobson (Fitness Suite)	All Years –Rounders- Miss Weaver, Miss Verrilli (Back Field) (This will be split in Year Groups) All Years – Fitness - Mr Dobson (Fitness Suite)
Thursday	All Years - Fitness - Mr Dean (Fitness Suite)	School Meetings (No Clubs)
Friday	All Years - Fitness – Miss Verrilli (Fitness Suite)	All Years - Fitness – Mr Lawrenson (Fitness Suite)
		Details: All Before school clubs will run from 7.30am – 8.30am unless stated All After school clubs will run from 3.10pm until 4.10pm Please speak to a member of staff who is running the club if further details required. Full PE kit is always expected to be worn for all extra-curricular activities.



Our New LRC

We are excited to share that our Library or Learning Resource Centre is becoming a vibrant hub for learning once again. This beautiful space is now being used regularly for reading interventions and small group work, helping to support students in a targeted calm and focused environment.

However, while the space itself is inspiring, our book collection is currently limited. Although we've begun investing in new titles, many of our reference books are outdated, and we are keen to provide students with a wider, more relevant range of reading materials.

We're reaching out to ask for your support. By following the link below and contributing through book tokens, you can help us restock our library with high-quality, engaging books that will benefit all students.

Your support could make a real difference.

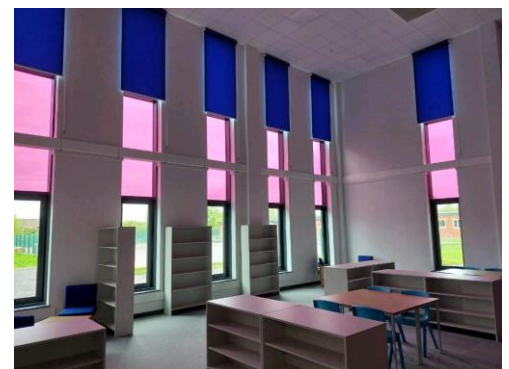

SEND at Shrewsbury Academy

If you have any concerns regarding a student's learning needs or would like to request additional support or advice, our **Student Support Team** is here to help.

For any SEN related queries, please do not hesitate to get in touch with the SEN Team: SENDadmin@shr.mmat.co.uk

Our **Special Educational Needs Coordinator (SENCO)**, **Laura Richmond**, works closely with the SEND team to ensure that every student receives the appropriate support. Laura is available to provide guidance, coordinate interventions, and respond to any SEND-related enquiries.

The **Student Support Department** is currently based in the **Bridge area of the Caradoc Building**, before moving to a refurbished purpose designed area of the school in September offering a central and accessible space for students.

We are also proud to have opened **The Lighthouse**—a purpose-built internal assessment and alternative provision area designed to meet a wide range of student needs in a calm and supportive environment.



Shrewsbury Academy in Our Community

ROYAL AIR FORCE
REGULAR AIR & RESERVE

NO ORDINARY JOB

FIND YOUR APPRENTICESHIP

The RAF is honoured and delighted to share the news that the Department of Education has officially recognised and ranked the RAF as number 4 in the top 100 Apprenticeship Employers 2024.

We offer Apprenticeships in the following roles:

- ENGINEERING**
Aircraft Technician (Avionics)
Aircraft Technician (Mechanical)
Weapons Technician
Electrician
Survival Equipment Specialist
Vehicle & Mechanical Equipment Technician
General Technician Workshop
- CYBERSPACE**
Communications Infrastructure Technician
Cyberspace Communication Specialist
- LOGISTICS**
Driver
Stores
Supplier
Chef
Air & Ground Steward
- AIR & SPACE OPERATIONS**
Air Traffic and Weapons Controller
Naval Officer
- SECURITY & RESILIENCE**
RAF Police
RAF Regiment Gunner

MEDICAL SERVICES
RAF Medical

INTELLIGENCE
Intelligence Analyst

PEOPLE OPERATIONS
Physical Training Instructor

To find out more about how we can help your students into an apprenticeship please contact our team on:
Email: CRN-CareersEngageMids@mod.gov.uk

Download our App to find out more about a career in the Royal Air Force

Apprenticeships 4



Some of our students have **severe allergies**. Please respect our children as a 'nut free school' and do not leave snacks and foods containing nuts at home.

Become a Junior Ambassador



Are you?

- ✓ Aged between 13-17
- ✓ Confident and Outgoing
- ✓ Interested in meeting people from around the world

Why Join?

- FREE Trips to Liverpool, Manchester, Alton Towers and many more....
- Join our discos and sports days at Shrewsbury School.
- Gain new skills and great life experiences.



JOIN NOW

equity@severnvalle.co.uk 01743 232505
www.severnvalle.co.uk

To Become an Ambassador please register through our website, email or by clicking **JOIN NOW**
Please note that all excursions and on-site activities are subject to availability and that on some excursions places may be limited

Most pharmacies can help you with **seven common conditions** without needing a GP appointment

- Sinusitis (adults and children aged 12 years and over)
- Sore throat (adults and children aged 5 years and over)
- Earache (children and young adults aged 1 year to 17 years)
- Infected insect bite (adults and children aged 1 year and over)
- Impetigo (adults and children aged 1 year and over)
- Shingles (adults aged 18 years and over)
- Urinary tract infection (women, aged 16 to 64 years)

Ask your pharmacy for more information about this free* NHS service

Visit your Pharmacy First!

*NHS prescription charge rules apply where a medicine is supplied



Click [here](#) to view our latest news articles.

Why not also follow us on Facebook [@ShrewsburyAcademy](#) for a wealth of content, from student, staff and school celebrations to competitions. We encourage you to get interactive with our posts!

To hear about news from across the Trust, why not also follow [@MarchesAcademyTrust](#).

Want to work for the Marches Multi Academy trust? Follow the link below:

<https://www.marchesacademytrust.co.uk/joining-us/how-to-join>



Shrewsbury Academy, Corndon Crescent, Shrewsbury, SY1 4LL
01743 276700
info@shr.mmat.co.uk
shrewsburyacademy.co.uk

